



country properties
village properties
town homes
barn conversions
building plots

Clover Court

Woodham, Newton Aycliffe, DL5 4UJ

Offers in the region of £195,000

NICK & GORDON
CARVER
RESIDENTIAL

*****3 BEDROOMS***** Offered for sale with NO ONWARD CHAIN, this detached bungalow occupies a corner plot within a pleasant cul-de-sac and features an extensive driveway leading to a DETACHED SINGLE GARAGE. An internal viewing will reveal a well proportioned lounge/dining room, built-in wardrobes to the principal bedroom and a refurbished bathroom/WC with separate corner shower cubicle. Externally there is a paved patio to the side of the property whilst to the rear there is an enclosed lawned garden. The property is equipped with gas central heating to radiators with combination boiler and uPVC double glazing throughout.





Services

Mains gas, (central heating to radiators), electricity and drainage.

No Onward Chain

The property is offered for sale with NO ONWARD CHAIN.

Local Authority

Durham County Council

Council Tax

Band D

Viewings

Strictly by appointment through our Newton Aycliffe office.

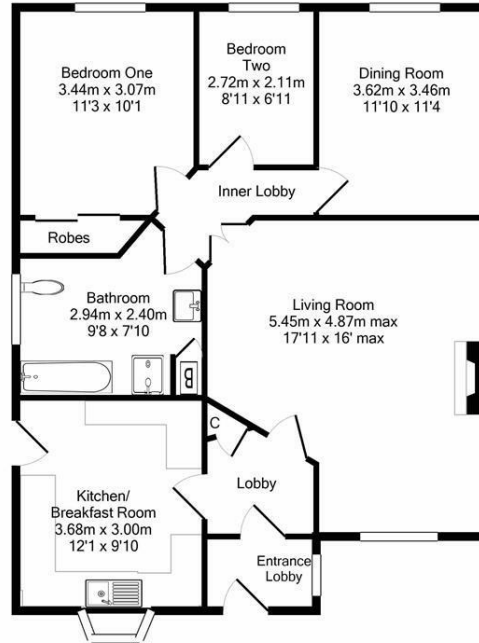
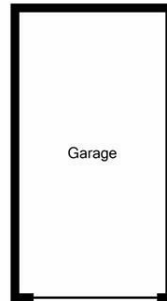

Energy Efficiency Rating		Current	Potential
Very energy efficient - lower running costs			
(92 plus) A			86
(81-91) B			
(69-80) C		68	
(55-68) D			
(39-54) E			
(21-38) F			
(1-20) G			
Not energy efficient - higher running costs			
England & Wales		EU Directive 2002/91/EC	

CLOVER COURT, NEWTON AYCLIFFE, DL5 4UJ.
TOTAL APPROX. FLOOR AREA 94.1 SQ.M. (1013 SQ.FT.)

Whilst every attempt has been made to ensure the accuracy of the floor plan contained here, measurements of doors, windows, rooms and any other items are approximate and no responsibility is taken for any error, omission, or mis-statement. This plan is for illustrative purposes only and should be used as such by any prospective purchaser. The services, systems and appliances shown have not been tested and no guarantee as to their operability or efficiency can be given.
Made with Metropix ©2021

We can search 1,000s of mortgages for you

It could take just 15 minutes with one of our specialist advisers:
Call: 01325 380088. Visit: Any of our Offices. Online: www.mortgageadvicebureau.com/carver



Your home may be repossessed if you do not keep up repayments on your mortgage. There will be a fee for mortgage advice. The actual amount you pay will depend upon your circumstances. The fee is up to 1% but a typical fee is 0.3% of the amount borrowed

MAB 6202



These particulars do not constitute any part of an offer or contract. None of the statements contained in these particulars are to be relied on as statements or representations of fact and any intending purchaser must satisfy himself by inspection or otherwise to the correctness of each of the statements contained in these particulars. The vendor does not make or give, and neither Nick & Gordon Carver Residential or Commercial, Nick & Gordon Carver, nor any person in their employment has any authority to make or give any representation or warranty whatever in relation to this property

80 High Street
Yarm, TS15 9AH
Tel: 01642 420090
yarm@carvergroup.co.uk

14 Duke Street, Darlington
County Durham, DL3 7AA
Tel: 01325 357807
sales@carvergroup.co.uk

26 Market Place, Richmond
North Yorkshire, DL10 4QG
Tel: 01748 825317
richmond@carvergroup.co.uk

43 Dalton Way, Newton Aycliffe
County Durham, DL5 4DJ
Tel: 01325 320676
aycliffe@carvergroup.co.uk

219 High Street, Northallerton
North Yorkshire, DL7 8LW
Tel: 01609 777710
northallerton@carvergroup.co.uk